

Pleasant Highlands



Superior Features. Exceptional Homes.



2018 Parade of Homes Winner
Best Floor Plan
Best Entertainment Area
Best Outdoor Living

2018 New Homes Tour | Most Livable Floor Plan
2017 Clark County BIA | Builder of the Year
2017 Clark County Parade of Homes Winner | Best in Show
2017 Building Excellence Award | Best New Home \$350k - \$500k



GENERATION HOMES
NORTH WEST

Pleasant Highlands

Community Map and Available Plans

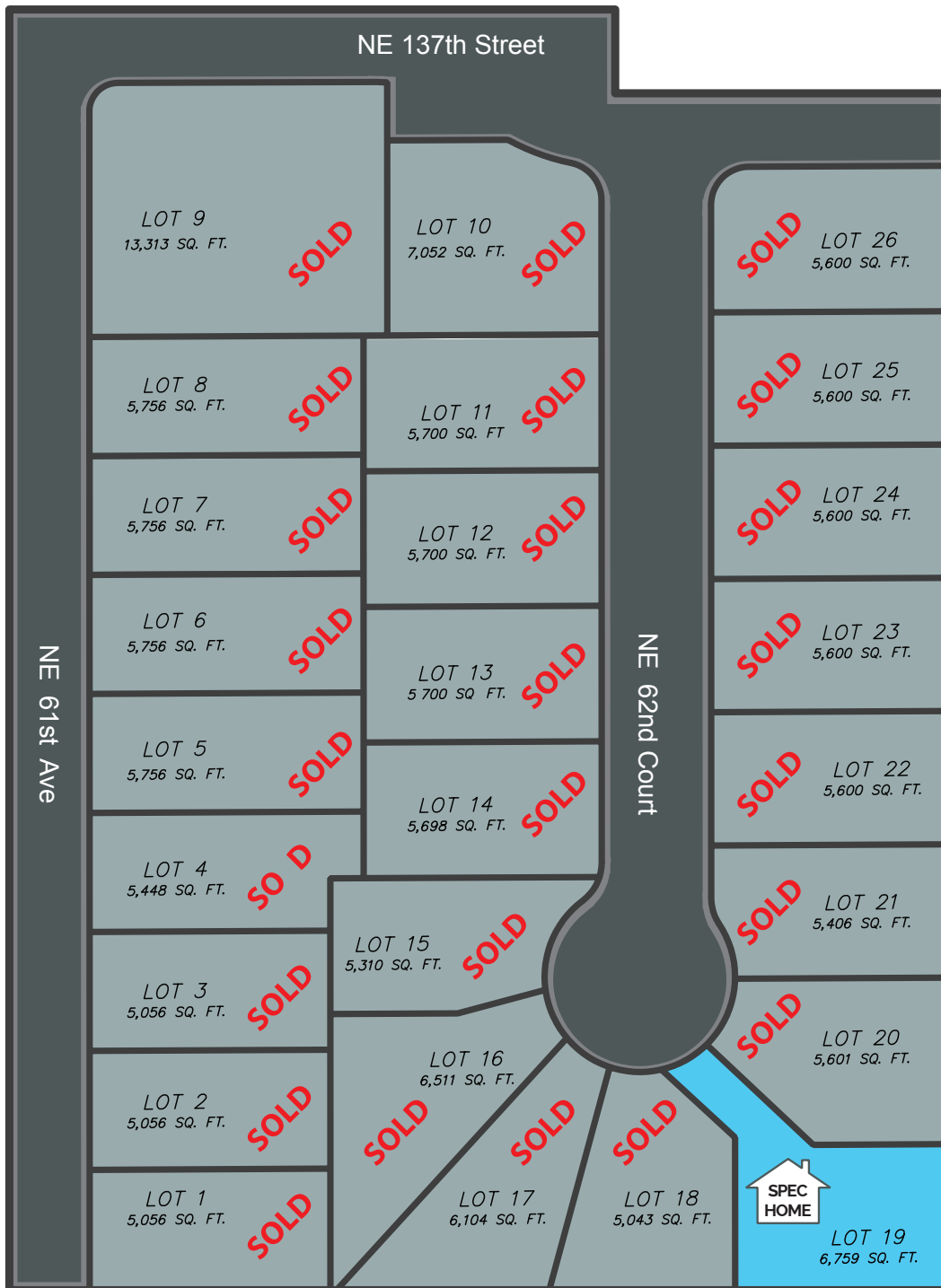

AVAILABLE LOTS

Lot 15	Plan 2343	\$479,900
Lot 19	Plan 2389	\$474,900

LOT PREMIUMS

■ \$3,000: 15, 19

SUPERIOR FEATURES INCLUDED

- 3 car garages most plans
- Tile Bathroom floors
- Full painted MDF window wraps
- Wood painted shelves in closets and pantry
- White painted trim package
- Custom color painted walls and ceilings
- Gas fireplace with stained block mantle
- Stone garage wings
- Stone posts and tapered columns
- Below ground sprinkler valves and back flow

CLIENT EXPERIENCE

- Home concept meeting
- No pressure home pricing quote
- Custom cabinet design center meeting
- Design meeting with flooring professional
- 1 on 1 construction meeting prior to start of home
- Quality customer care during construction
- Home orientation walk through
- 1-year builder warranty

CONSTRUCTION AND EXTERIOR

- 9ft Ceilings first floor
- 8ft Ceilings second floor
- Kiln dried lumber
- 2x6 construction
- I-joist engineered floors
- 100sq. ft. concrete back patio
- Covered back patios per plan
- Lifetime architectural roofing
- James Hardie Fiber cement siding system
- Wayne Dalton insulated garage doors w/windows
- Full landscaping
- Front and back sod, bark and 5 plants
- Full Sprinkler systems
- Below ground sprinkler valves and back flow
- Backyard 6ft pre-stained cedar fencing
- Stone accents with stone garage wings
- Stone posts and tapered columns

KITCHEN FEATURES

- Custom designed kitchen cabinets
- Wide variety of custom cabinet selections
- GE freestanding gas range/stove/dishwasher/microhood
- Delta Nickel kitchen fixture
- Laminate wood floors
- Granite or Quartz slabs in kitchen
- Recessed can lighting (5)
- Garbage disposal
- Plumbed for icemaker

INTERIOR FEATURES

- Gas fireplace with Stained Block Mantle
- Custom hard surface allowance includes laminate wood floors, tile bathroom floors, slab and tile countertops
- 3.5 inch base and door wraps
- Full painted MDF window wraps
- 6/8" interior 2 panel doors
- Oil rubbed bronze or satin nickel hardware
- Wood painted shelves in pantry and closets
- 2 interior paint colors (trim/walls, ceiling) with High-gloss white painted trim package
- Custom color painted walls and ceilings
- Delta Chrome bathroom fixtures
- Nickel door hardware /handle package
- Chrome bathroom hardware package
- Gerber sinks and toilets
- Nickel lighting package
- Garage finished through drywall tape

TECHNOLOGY AND ENERGY EFFICIENT SYSTEMS

- Energy Efficient Homes
- Energy Efficient Certified vinyl windows
- Energy Star Certified Forced Air Furnace
- Rinnai Tankless water heater
- Carbon Monoxide Detectors
- A/C pre-plumb
- R-38 Insulation in floors
- R-49 Insulation in ceilings
- R-22 Insulation in walls
- Central networking panel

WARRANTY

- 1 Year Builder Workmanship
- 2 Years Systems
- 10 Years Structural

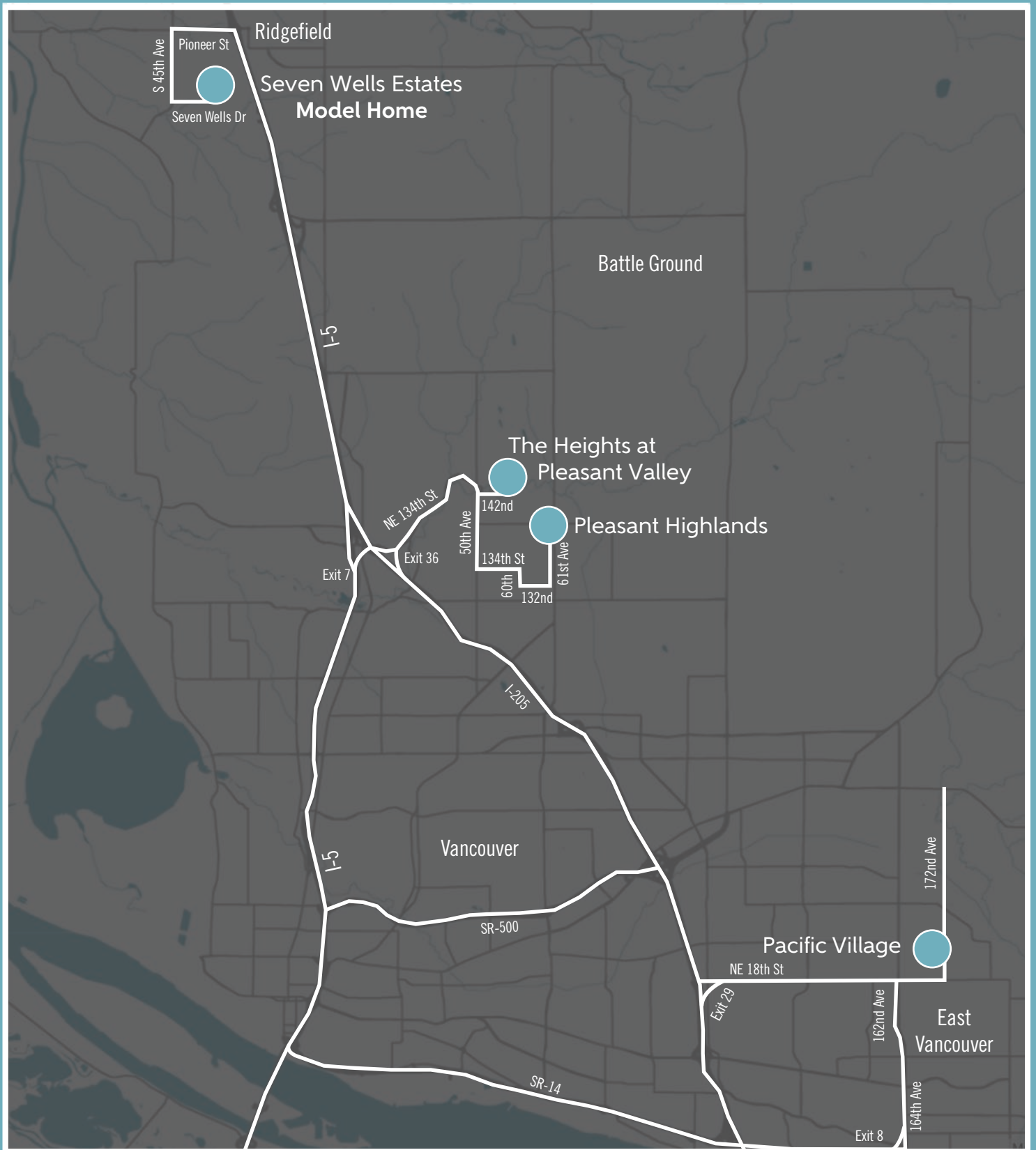

Seven Wells Estates | Model Home
1604 S N 47th Pl, Ridgefield, WA 98642

The Heights at Pleasant Valley
14101 Northeast 50th Ave, Vancouver, WA 98686

Pacific Village
2814 NE 171st Ave, Vancouver, WA 98682

Pleasant Highlands
12709 NE 58th Ave, Vancouver, WA 98686



GENERATION HOMES
N O R T H W E S T
(360) 355-3363
www.generationhomesnw.com